

# 毅永企業有限公司 E-YUNG ENTERPRISE CO., LTD.

REV	ZONE	REVISION	DATE

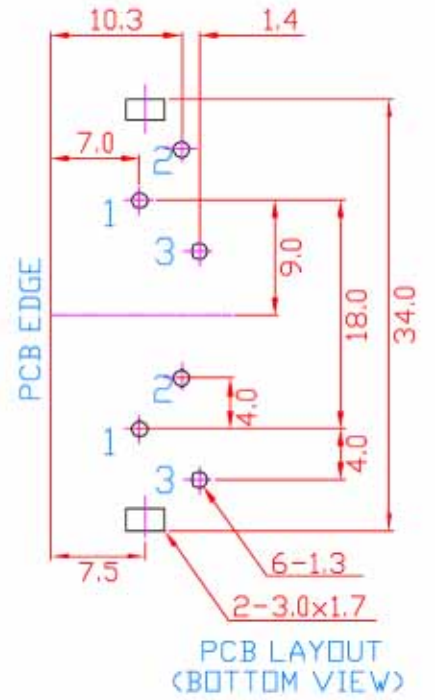
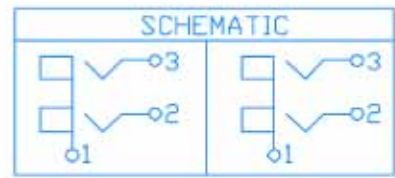
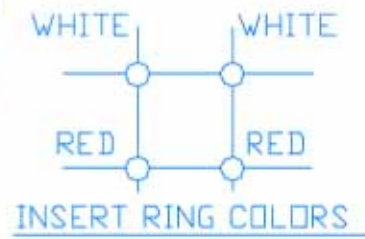
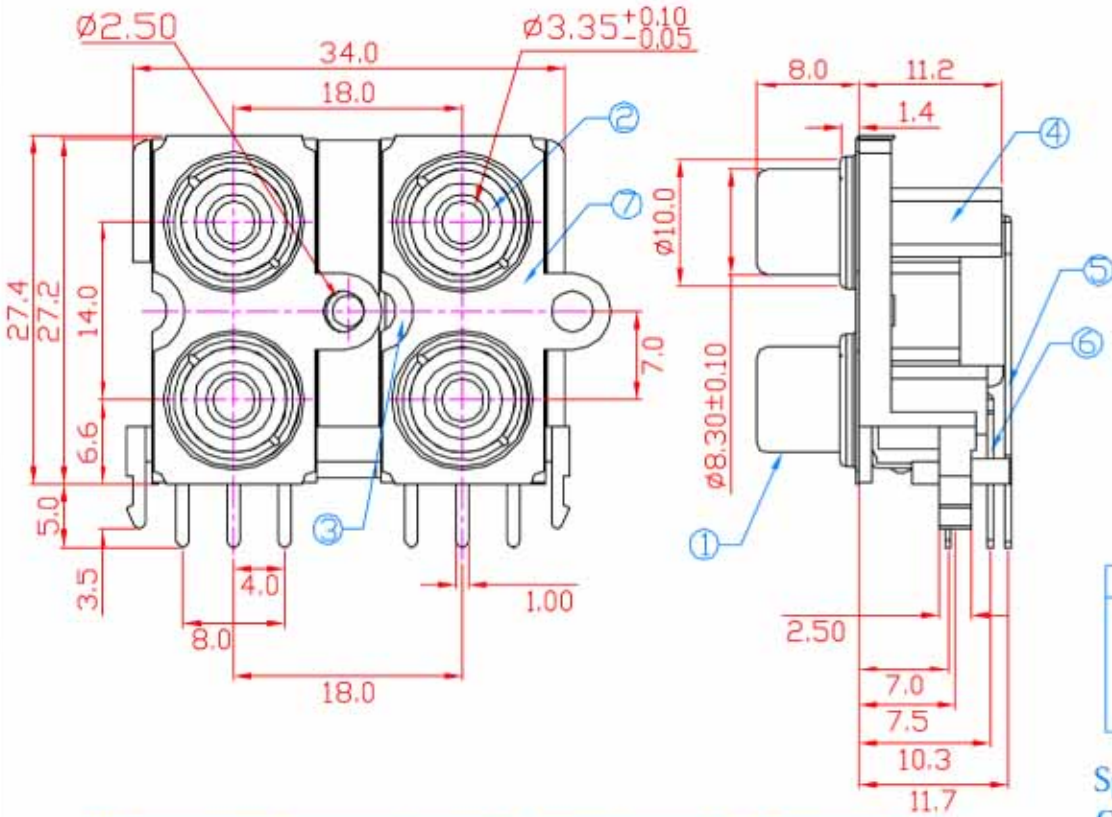

NO.	NAME	MATERIAL	FINISH	Q'TY
1	BARREL	BRASS T:0.4	NICKEL PLATED	2
2	INSERT RING	PBT G.F.	WHITE/RED	4
3	COVER	ABS	BLACK	2
4	HOUSING	ABS	WHITE	1
5	TERMINAL	BRASS T:0.5	TIN PLATED	2
6	TERMINAL	BRASS T:0.5	TIN PLATED	2
7	SHIELD COVER	BRASS T:0.5	TIN PLATED	2

**Specification:**  
 Contact Resistance: 30m Ohm. Max. At AC 100mA Max.1KHz  
 Insulation Resistance: 100M Ohm Min. At 500V DC  
 Rated Voltage And Current: DC 12V,2A Max ; AC 100V,1A Max.  
 Dielectric Withstanding Voltage: 500VAC At 60Hz For 1 Minute  
 Durability (Life Test): 4000 Cycles  
 Insertion Force: 0.3~3.0 Kg  
 Extraction Force: 0.3~3.0Kg