

## TD-0341 SERIES

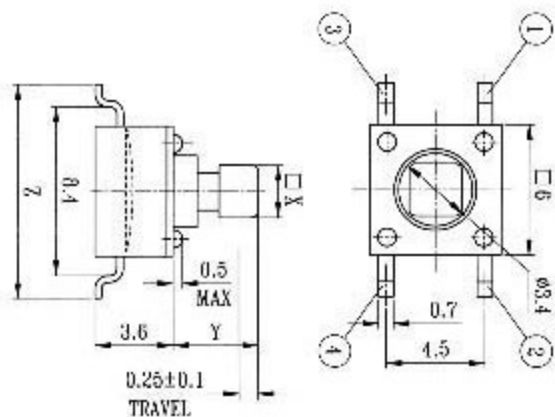

MODEL NO.	Stem Dimension (mm)	Stem Length(mm)	Terminal Length x (mm)
TD-0341	2.4 x 2.4	3.6	10
TD-0342	2.4 x 2.4	3.9	10
TD-0381	2.4 x 2.4	3.6	10
TD-0641	2.8 x 2.8	3.6	8
TD-0642	2.4 x 2.4	3.9	8
TD-0681	2.8 x 2.8	3.6	8

CODE	OPERATING FORCE(gf)
T	100 ± 30
V	130 ± 30
X	160 ± 50
W	170 ± 50
y	190 ± 50
z	250 ± 100

### CIRCUIT DIAGRAM

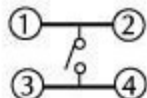

### SPECIFICATIONS

1. RATING : DC 12V 50mA
2. TRAVEL : 0.25 ± 0.1mm
3. CONTACT RESISTANCE 100 mΩ MAX