

## TC-0250 SERIES

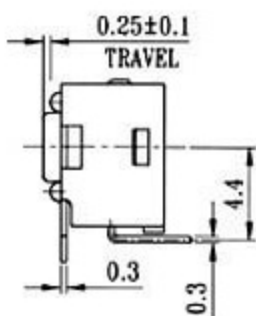
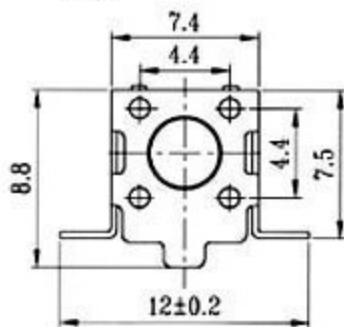
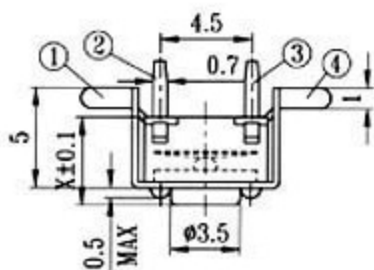

MODEL NO.	Stem length(mm)
TC-0250	4.3
TC-0251	5
TC-0252	7
TC-0253	9.5
TC-0254	8
TC-0255	12.5
TC-0256	7.3

CODE	OPERATING FORCE (gf)
T	100 ± 30
V	130 ± 30
X	160 ± 50
W	170 ± 50
Y	190 ± 50
Z	250 ± 100

### CIRCUIT DIAGRAM

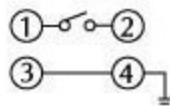

### SPECIFICATIONS

1. RATING : DC 12V 50mA
2. TRAVEL : 0.25 ± 0.1mm
3. CONTACT RESISTANCE 100 mΩ MAX